



Arts in Motion

January 23, 2010

Welcome to the 3rd Annual

ARTS IN MOTION

Winterguard/Percussion Competition

sponsored by the Harrison High School Band Boosters!

We are pleased to welcome you to our school as we host our 2010 SAPA Color Guard and Percussion Competition. This packet will provide information about our event including check in and prop information, directions, parking, concessions, etc. Should you have any questions not addressed in this packet, please contact Donna Cutcliff at 770-639-9364 or email donna@harrisonbands.org.

Contact Sponsor: Harrison High Band Boosters
Contest Manager Donna Cutcliff 770-639-9364
Day of the event Hot Line: 678-524-4135

Practice Sites

Practice space will be available on a first come, first serve basis at \$20 per ½ hour. Practice locations will be available at another area school no further than 5 miles from Harrison. Please contact Janet Ellis, at 770-426-8455 to schedule time. All checks must be made payable to HHBB. A practice contract is enclosed.

Parking

Entrances at the school will be clearly marked for both competing units and spectators. Parking attendants can help direct you if you have any questions regarding parking. Any unit with a large truck or tractor trailer will need to enter at the school at the bus port entrance. This too will be clearly marked and will have an attendant available.

Unit Check-in

Groups with passenger vehicles or small trailers will enter the school's main entrance and follow the signs to Unit & Equipment check-in. Units are required to report the number of competing members and penalties will be assessed for false declarations. Arm bands will be provided for competing members plus seven. **Only persons with unit based arm bands on will be allowed in the equipment/unit hallways.** Additional arm bands may be purchased for \$8/ea at unit check-in. Units must check-in one hour prior to performance time. Competing members and crew must check-in together. Please be prepared to turn in your spiel sheet at check-in if you have not already submitted them to SAPA.

Retreat Line Up

The small gym next to the performance gym (mat refolding area) will be where the CO's will line up for Retreat. All retreats are CO's only.

Spectator Admission/Entrance

Spectator admission will be \$8 per SAPA guidelines. A separate spectator entrance will be clearly marked.

Footwear

To ensure the safety of each performer, *all units must wear shoes when not performing.*

Performance Music

Please provide your unit's performance music to the sound coordinator immediately following unit check-in. Formats accepted are CD or MP3. Sound testing and volume control will be managed by SAPA. If you have an iPhone or iPod Touch, please be sure to have another way to play your music at shows (another iPod, mp3 player, or cd). Even in airplane mode, incoming calls can interfere with the sound quality, and WiFi access can do the same for the iPod Touch.

Prop and Floor Storage

Props and floors may be stored in the equipment storage area on the unit/equipment entrance hallway. Due to limited space, units are asked not bring your equipment any sooner than 1 hour before your performance. You may return your props, floors and equipment to the storage area for no more than 1 hour after your performance. **DO TO THE LARGE VOLUME OF UNIT PARTICIPATION THIS YEAR, WE ASK THAT AFTER YOUR RETREAT, YOUR HALLWAY STORAGE AREA BE CLEARED TO WELCOME THE NEXT GROUP OF UNITS!** Thank you.

Dressing Facilities

Both boys' and girls' dressing rooms are available onsite. Personal belongings will be stored in school hallways, again please clear the hallways of personal belongings immediately after retreat. These hallways will only be used to store personal belongings for competing units. The hallways will be monitored by an attendant but security of belongings cannot be guaranteed. Please keep all valuables secured. You are welcome to stretch in the hallways, however, please be mindful of loud music.

Equipment Inspection

All equipment tips on rifles, flags and sabers must be padded and taped. Props must also be protected so as not to damage the floor. Equipment inspection will occur prior to entering body warm up.

Warm Up Areas

Body warm up and equipment warm up will be in separate areas. You may elect to spin in body warm up, but no tossing. You may toss in Equipment Warm Up, however please be mindful of the ceiling projector. Units may not enter warm up areas until SAPA published timelines.

Unit Guides

Upon check in, every unit will be assigned a volunteer Guide. While we respect that you may have done this for years and do not feel you need the services of a guide, to ensure the safety of the units and their timing of movement throughout the school, please understand every Unit must have a guide. Your Unit Guide will meet you in your designated personal belonging storage area 20 minutes prior to the scheduled body warm up. You will be escorted to body warm up at the appropriate time. The Unit Guide will stay with you through your performance. A volunteer guide will escort you from mat refolding back to the personal belonging storage area. Timing for each area is determined by the published SAPA schedule.

Competition Floor Size

The maximum allowable floor size for any unit is 55' X 90'.

Timeline

Our timeline will be horizontal. From the judges' perspective, units will enter from the left rear of the gym and exit on the left front. The floor will be pulled from the rear sideline to the front. Upon entry, you may pull the floor to the halfway point, and then await notification from the timing judge to proceed.

Video Taping

Due to copyright restrictions, NO ONE, NOT EVEN THE CONTEST SPONSOR, IS TO VIDEO TAPE any part of the contest, EXCEPT a unit videotaping THEIR OWN performance. You will be provided ONE video pass at check-in. There can be NO SELLING of contest videos.

Judges' Tapes, Score Sheets and Recaps

All units may pickup judges' tapes, score sheets and recaps at the table adjacent to the sound/announcers' table shortly after your unit's performance.

Awards

All units will receive certificates for participation as provided by SAPA. The top three (3) scoring units in each SAPA judged class will receive awards.

Critique

The SAPA Contest Director will determine the details of unit critique. This will take place in the Critique room just off Hallway E. Signs will mark the location.

Floor Damage

In order to protect SAPA and the Contest Sponsor, please utilize the Floor Damage Report included in this packet. The form is to be used by the Timing & Penalty Judge as well as the Contest Director to inform a Unit Manager of the damage caused to the floor. The original form should be given to the Unit Manager and two extra copies made, one for the Contest Director and one sent to the SAPA office.

First Aid

A First Aid station will be located in Hallway F adjacent to the performance gym. The area will be clearly marked with signs. If your unit is not in body or equipment warm up, you may access first aid through the E Hallway. Directional signs will also be located in the unit/equipment entrance hallway.

Hospitality

A hospitality suite will be provided for the Judges and the Directors. The food will be centrally located. The Judges' Hospitality Room and Tabulation area will be located in the lounge adjacent to the equipment storage area, a short walk from the suite. The Directors' Hospitality Room will be located in Hallway E, adjacent to the suite. Signs for each area will be located in the unit/equipment entrance hallway to direct you to the proper area.

Hotels

A list of hotels in the area is enclosed.

Area Restaurants

A list of restaurants in the area is enclosed.

Concessions

Concessions will be provided onsite and will include Chick Fil-A, BBQ Sandwiches, Grilled Cheese, Baked Potatoes, Chili, Nacho's and Hot Dogs. Other menu items include chips, candy, popcorn and fruit. We will also have soda, tea, PowerAde, water, coffee and hot chocolate. Prices will range from \$5 to 50¢.

Unit Name: _____

Number of Performing Members: _____

Practice Site Cost (\$20 per 1/2 hr)

Number of 1/2 hr increments _____ X \$20 = _____

Entrance Fees

Number of passes _____ X \$ 8 = _____

Total Due

- SAPA Unit Spiel Sheet
- Practice Site Contract
- Schedule
- 7 Armbands
- Maps

Payment Type	Amount
Cash	_____
Check# _____	_____
Please make checks payable to HHBB	

Practice Site Contract

Unit Name: _____

Contact: _____

Address: _____

Email: _____

Phone: _____

Requested practice date, hours and times:

Date: _____ Between _____ and _____

Date: _____ Between _____ and _____

Date: _____ Between _____ and _____

We acknowledge practice time charges are \$20 per ½ hour. Payment is due at check in.
Contracted times which are not used will not be refunded unless suitable arrangements are made in advance with the contest sponsor PRIOR to check in.

Make checks payable to HHBB.

Signed: _____ Print Name: _____

Title/position: _____

Email to: janet_ellis@comcast.net

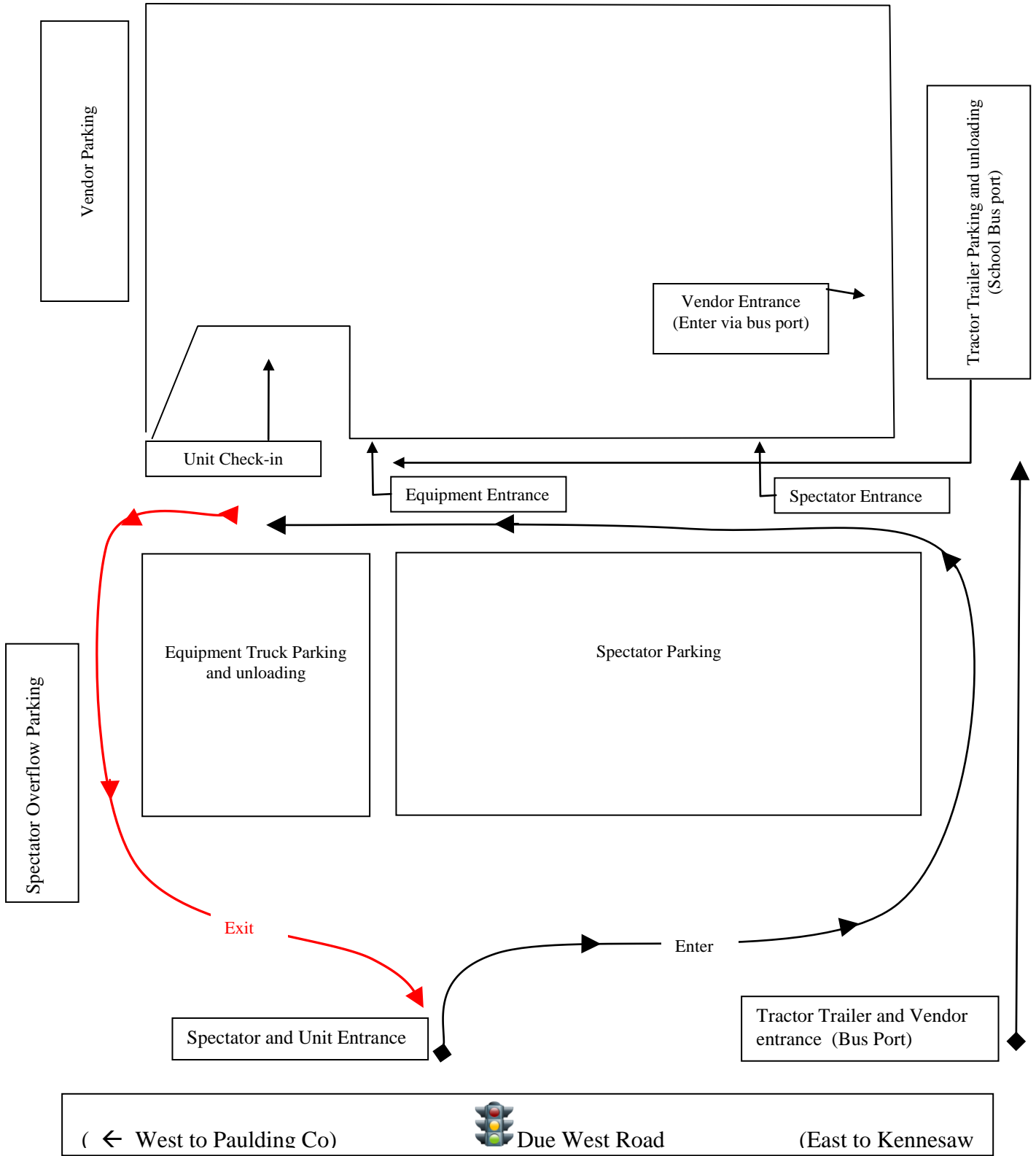

(← West to Paulding Co)



Due West Road

(East to Kennesaw)

Competition Area

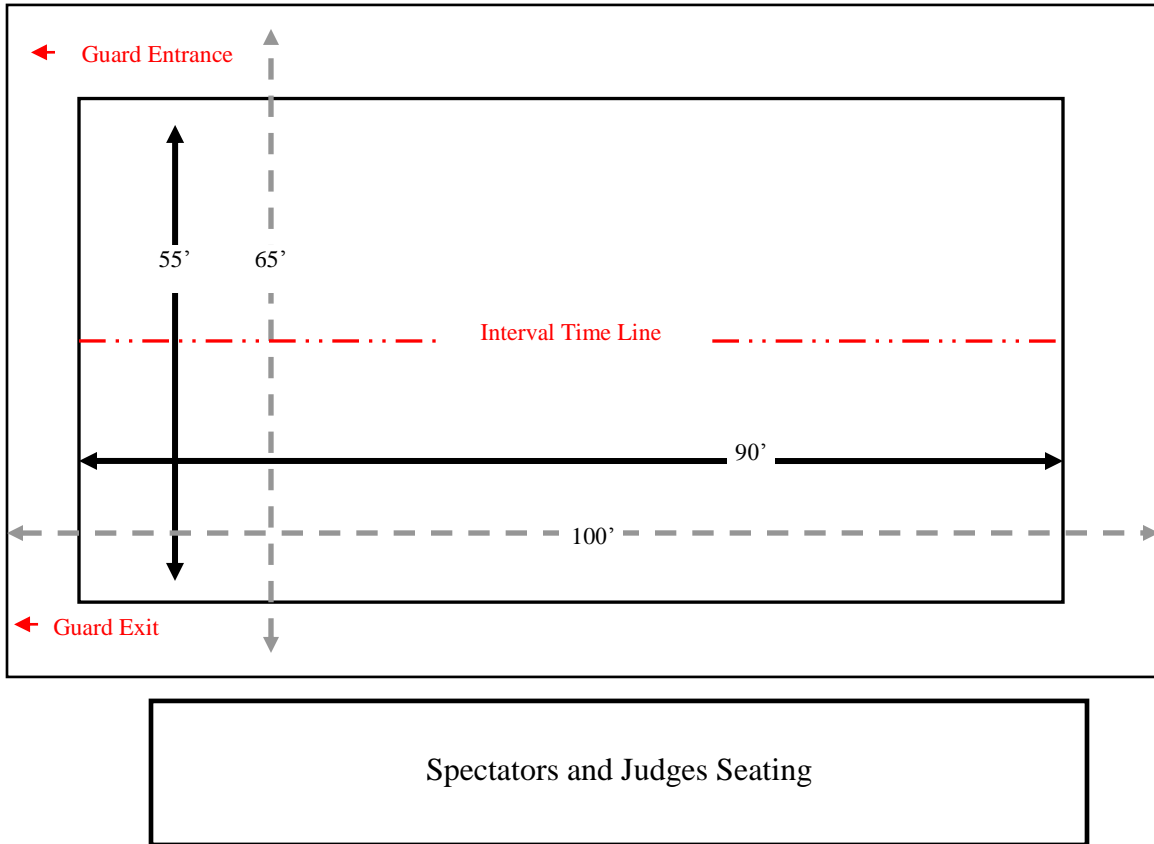

Harrison High School
 4500 Due West Road
 Kennesaw, GA 30152
 Contest Hotline 770-639-9364

Concessions and Dining Area

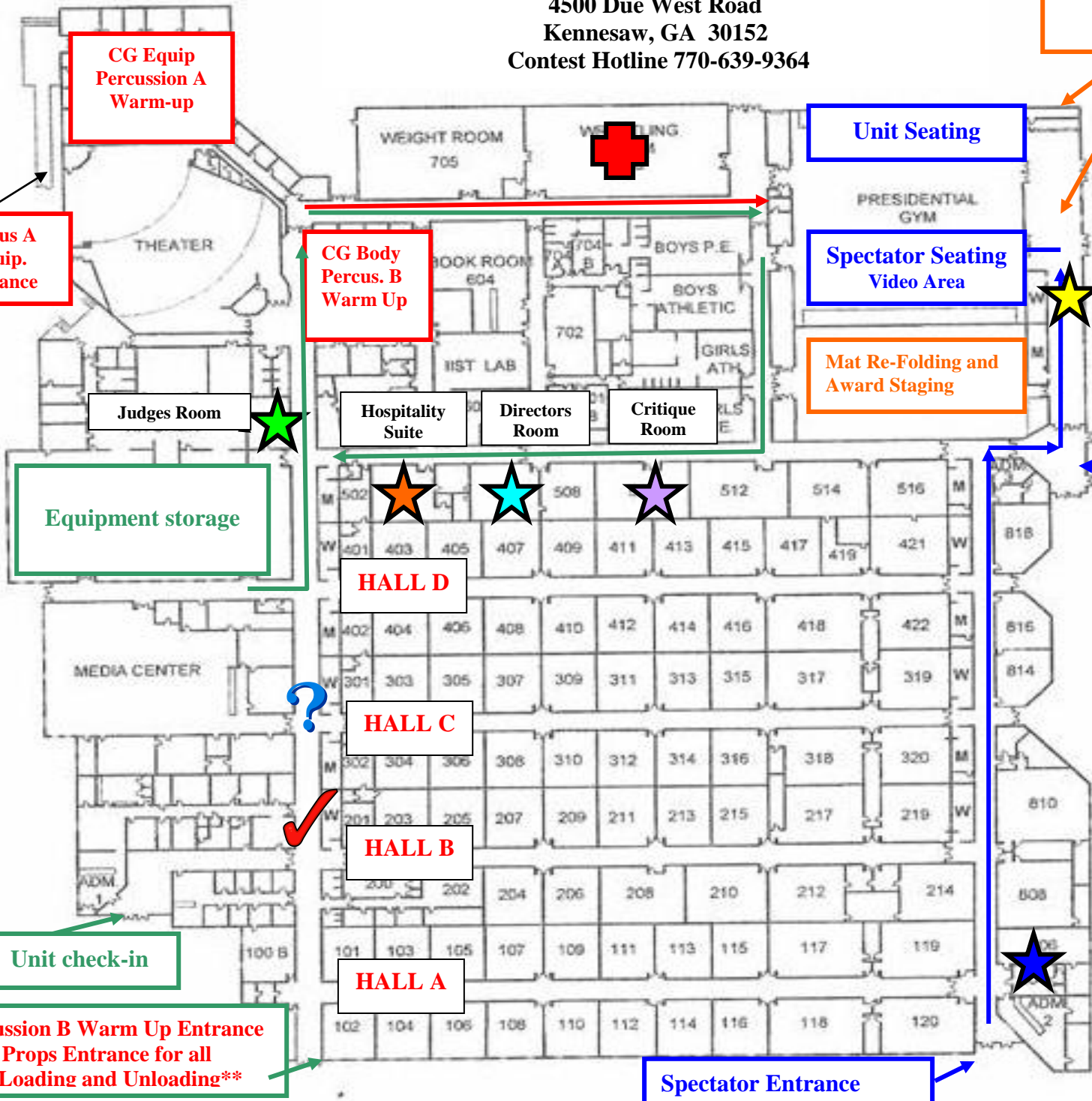

Tractor Trailer Parking (Bus port) (Right side of school)
 Unit Equipment Parking located in the front parking lot adjacent to props entrance/loading zone

- Spectator Ticket Sales
- Vendor Sales
- Judges' Room
- Directors' Room
- Critique Room
- Hospitality Suite
- First Aid
- Information
- Armband Checkpoint

Vendor Only Entrance

Spectator/Unit/Equipment Parking (School front parking lot)

Percus A Equip. Entrance

CG Equip Percussion A Warm-up

CG Body Percus. B Warm Up

Equipment storage

Unit check-in

Percussion B Warm Up Entrance
 Props Entrance for all
 Loading and Unloading

Spectator Entrance

SAPA Floor Damage Form

Please clearly mark any damage to the competition floor.

Contest _____ Date _____

Unit _____ Class _____

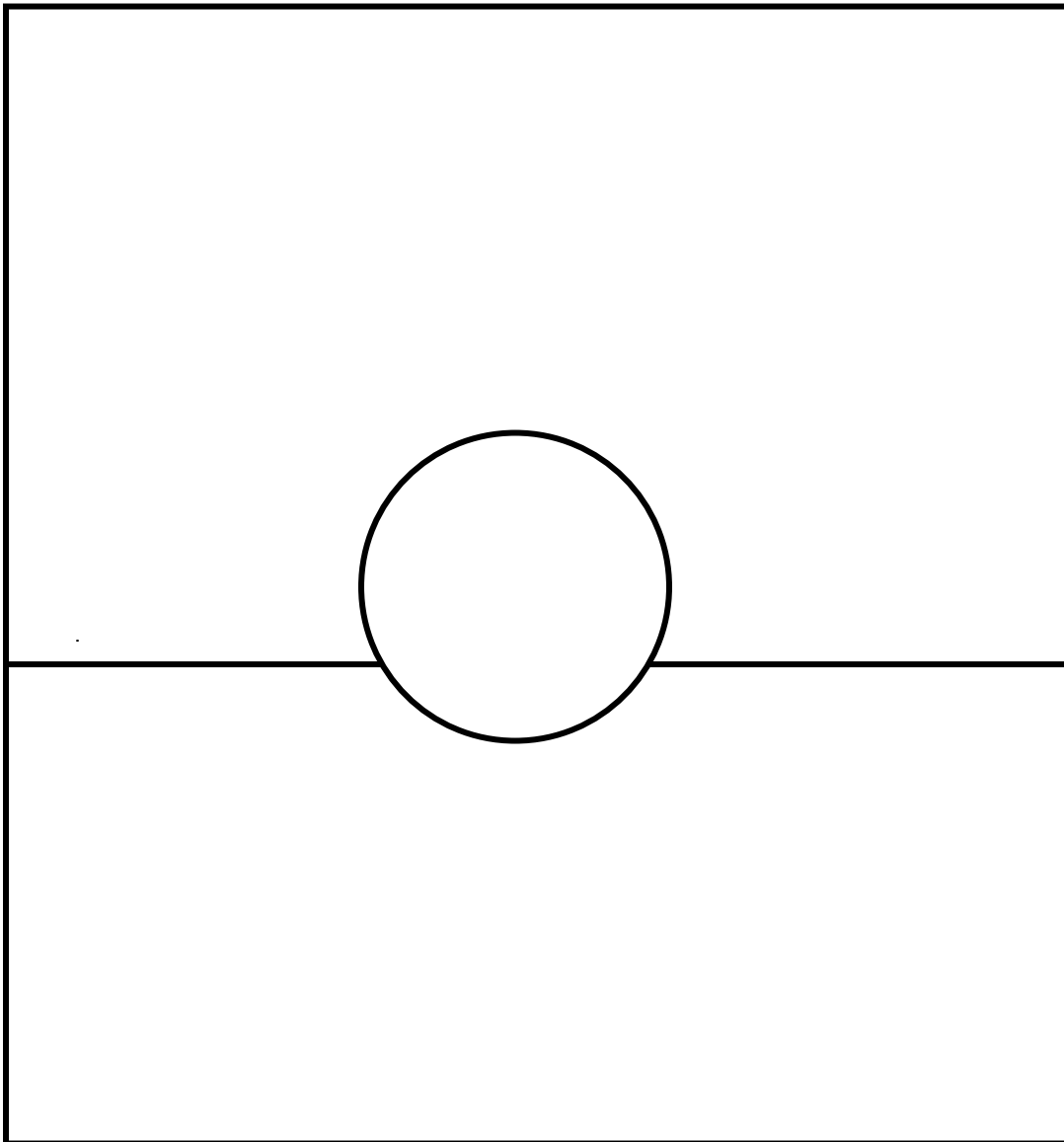

T & P Judge _____

Show Coordinator _____

Unit Manager _____

Contest Sponsor _____

Directions

Harrison High School is located at 4500 Due West Road in Kennesaw, GA 30152

From I75 Northbound. Exit 271 Chastain Road and turn left. Travel approximately 4 miles to Hwy 41/Cobb Parkway and turn right. In approximately $\frac{1}{4}$ mile at the first light turn left on Kennesaw Due West Road (note road name will change to Due West). This intersection will have a SAPA Winterguard Contest sign with an arrow pointing the way. Travel approximately 6 miles to Harrison High School.

From I75 Southbound. Exit 271 Chastain Road and turn right. Travel approximately 4 miles to Hwy 41/Cobb Parkway and turn right. In approximately $\frac{1}{4}$ mile at the first light turn left on Kennesaw Due West Road (note road name will change to Due West). This intersection will have a SAPA Winterguard Contest sign with an arrow pointing the way. Travel approximately 6 miles to Harrison High School.

From I20 Eastbound. Exit 44 Thornton Road and turn left. Continue approximately 10 miles to Richard D Sailors Parkway and turn right. At the second red light, turn left on New Macland Rd/Hwy 176 (road name changes to Lost Mountain, then changes again to Mars Hill). Travel approximately 8 miles to Due West Road and turn right. This intersection will have a SAPA Winterguard Contest sign with an arrow pointing the way. Travel approximately 1 mile to Harrison High School.

*Local Contact List**Hospitals / Medical Centers*

Wellstar Kennestone Hospital	675 Church Street Marietta, GA 30060	770-422-0111
------------------------------	---	--------------

Police

Cobb County Police (Precinct 5)	4640 Dallas Highway Powder Springs, GA 30127	770-499-4185
------------------------------------	---	--------------

Ambulance

Georgia EMS	2670 Cobb Pkwy NW Kennesaw, GA 30152	770-514-8070
-------------	---	--------------

Towing

Cobb County Towing	2486 S Main St NW Kennesaw, GA 30144	770-419-9001
J. Abney Automotive	2600 Stilesboro Rd NW Kennesaw, GA 30152	770-428-8233
Marietta Wrecker Service	950 Allgood Rd Marietta, GA 30062	770-422-6614

Garages

America's Service Station	1830 Mars Hill Rd NW Acworth, GA	770-218-3497
J. Abney Automotive	2600 Stilesboro Rd NW Kennesaw, GA 30152	770-428-8233

Gas Stations

Chevron	1727 Mars Hill Rd NW # 108 Acworth, GA 30101	770-590-0972
Kroger	1720 Mars Hill Rd NW, Acworth, GA 30101	770-419-5490
Chevron	5115 Dallas Hwy Powder Springs, GA 30127	770-427-0931

General Merchandise

Wal*Mart	3105 Cobb Parkway North, Acworth, GA 30101	770-974-5119
Wal*Mart	3615 Marietta Hwy Dallas, GA 30157	770-445-9388
Target	3378 Cobb Pkwy NW Acworth, GA 30101	678-202-0996

Restaurants / Retail

Avenue West Cobb	3625 Dallas Hwy SW	678-594-6738
Barnes & Noble	Marietta, GA 30064	
American Eagle		
Gap		
Ann Taylor		
Talbot's		
Chili's		
Aspen Steakhouse		
Macaroni Grill		
Panera Bread Co		
Ted's Montana Grill		
Daily Grind	Due West Road (left out of the school, on Right past Midway Rd)	770-422-9480
Shane's Rib Shack	3894 Due West Rd NW Marietta, GA 30152	678-290-0053
Wendy's	45 Mars Hills Road Powder Springs, GA 30127	770-425-2286
McDonald's	1855 Mars Hill Rd NW Acworth, GA 30101	770-218-9065
Subway	5200 Dallas Hwy Powder Springs, GA 30127	770-421-8553
Subway	1720 Mars Hill Rd NW # 4 Acworth, GA 30101	678-355-6035
Gondelier Pizza	1720 Mars Hill Rd NW # 4 Acworth, GA 30101	770-425-5006
Waffle House	1862 Mars Hill Rd NW Acworth, GA 30101	678-355-0397

Hotels

Green Roof Inn & Suites	3027 Cobb Parkway NW Kennesaw, GA 30152	800-733-5916
La Quinta Inn	2625 George Busbee Parkway Kennesaw, GA 30144	800-531-5900
Best Western Inn	3375 Busbee Drive Kennesaw, GA 30144	770-424-7666
Holiday Inn Express	2485 George Busbee Parkway Kennesaw, GA 30144	770-427-5210
Fairfield Inn by Marriott	3425 Busbee Drive Kennesaw, GA 30144	770-427-9700
Comfort Inn	2489 George Busbee Parkway Kennesaw, GA 30144	770-499-9200

Florist

Kroger	1720 Mars Hill Rd NW Acworth, GA 30101	770-419-5490
Publix	1727 Mars Hill Rd NW Acworth, GA 30101-8090	770-218-2420

Event Contacts

Donna Cutcliff		770-639-9364
----------------	--	--------------

Emergency On-Site Contacts

Donna Cutcliff		770-639-9364
Emergency		678-524-4135

SAPA Contest Administrator

Keith Guier		770-949-0900
-------------	--	--------------

Transportation Chair

Lance Smith		678-982-4579
-------------	--	--------------